



47, Crayford Way, Dartford DA1 4JY  
Asking Price £375,000



Ideally positioned, this spacious extended end-of-terrace home offers two generous double bedrooms and sits just a short walk from Crayford High Street, placing shops, restaurants, Crayford station and excellent transport links within easy reach. Well presented throughout, the ground floor features an inviting entrance hall, a convenient WC, a bright reception room and a well-proportioned kitchen/breakfast room. Upstairs, you will find two double bedrooms and a bathroom. Perfect for first-time buyers, the property further benefits from double glazing, electric storage heating, off-street parking and both front and rear gardens. Early viewing is highly recommended.

Local Authority: {prop\_LA\_county}  
 Council Tax Band: {council\_tax\_band}



**01322 553322**

60-62 High Street, Bexley, Kent, DA5 1AH

bexley@parkestates.co.uk  
 www.parkestates.co.uk

## Crayford Way, DA1

Approximate Gross Internal Area  
 83.0 sq m / 894 sq ft

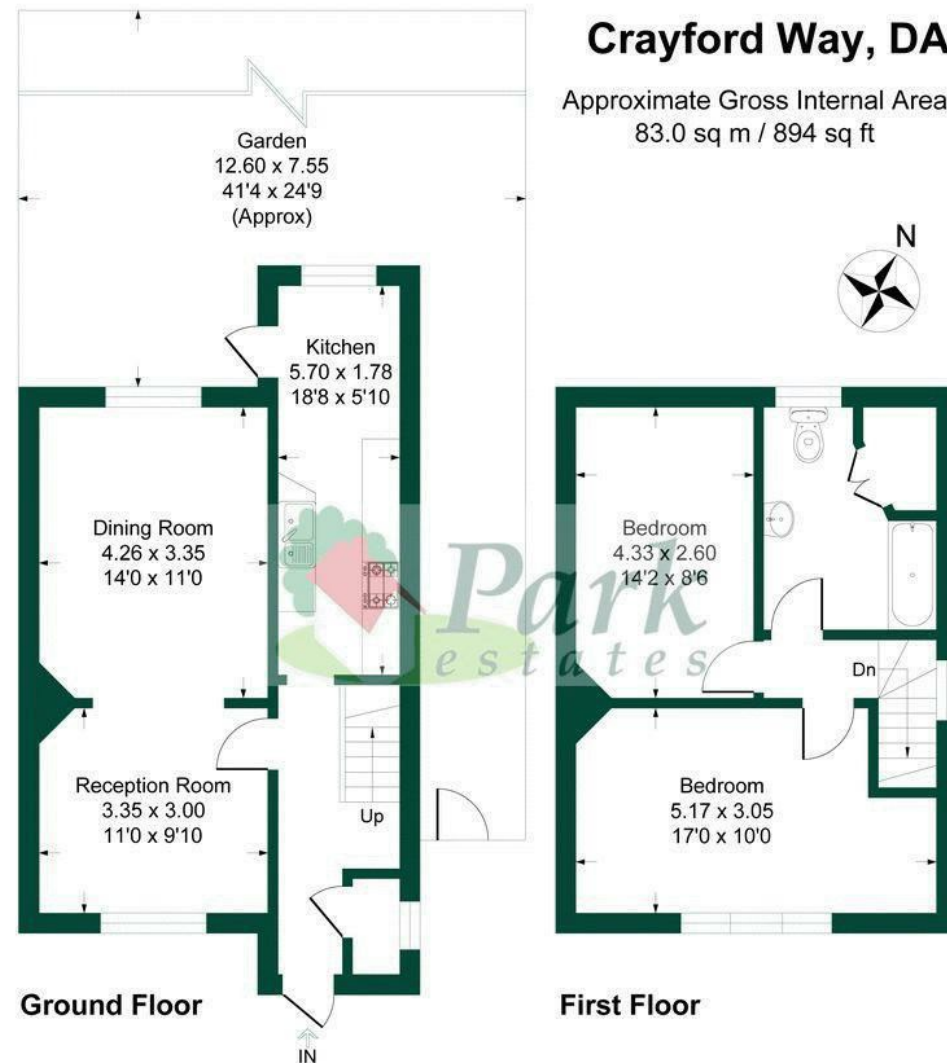

This plan is for layout guidance only. Not drawn to scale unless stated. Windows and door openings are approximate. Whilst every care is taken in the preparation of this plan, please check all dimensions, shapes and compass bearings before making any decisions reliant upon them.  
 Produced By Planpix

Every care has been taken with the preparation of details, but accuracy is in no way guaranteed. These particulars do not constitute a contract and are issued and accepted on the express understanding that all negotiations will be conducted through Park Estates. The seller does not make or give, nor do we or our employees have any authority to give a representation or warranty in relation to the property. Please contact this office before viewing the property. If there is any point which is of particular importance to you, we will be pleased to check the information for you and confirm that the property remains available. This is particularly important if you are contemplating travelling some distance to view the property. We would strongly recommend that all the information that we provide about the property is verified by yourself on inspection and also by your conveyancer, especially where statements have been made by us to the effect that the information provided by us has not been verified.